

ABERNATHY and ASSOCIATES

Kenneth B. Abernathy Jr.

Wisconsin Registered Land Surveyor S-1594

W4056 Bray Road
Elkhorn, Wisconsin 53121
Phone: (414) 723-4260 (office)
(414) 723-4813 (residence)

PLAT OF SURVEY

Lot 18 of Evergreen Estates Subdivision, located in the Southwest 1/4 of the Northwest 1/4 and the Southwest 1/4 of the Southwest 1/4 and the Northwest 1/4 of the Southwest 1/4 and the Northeast 1/4 of the Southwest 1/4 and the Southeast 1/4 of the Southwest 1/4 of Section 18, and the Southwest 1/4 of the Northwest 1/4 and the Northwest 1/4 of the Northwest 1/4 and the Northeast 1/4 of the Northwest 1/4 and the Southeast 1/4 of the Northwest 1/4 and the Northwest 1/4 of the Northeast 1/4 of Section 19, Town 3 North, Range 17 East, Town of La Fayette, County of Walworth, State of Wisconsin.

Owners: Preferred Homes, Inc.
2903 borg Rd.
Delavan, Wisconsin 53115

Overlook Court
66' Wide

Edge of Blacktop Roadway Pavement

S 83°04'58.5" E 228.08'

Radius = 800.02'
Arc = 228.86'

NOTE:

WOOD STAKES HAVE BEEN PLACED AT BUILDING CORNERS. BUILDER IS TO VERIFY DIMENSIONS WHICH HAVE BEEN ROUNDED TO THE NEAREST TENTH OF A FOOT TO INSURE PROPER PLAN INTERPRETATION AND CONTACT THIS OFFICE IMMEDIATELY IF ANY DISCREPANCY EXISTS.

SOILS TEST AREA

Lot 18
0.51 Acres ±

EXISTING RESIDENCE
FOUNDATION COMPLETE 11/14/95

PROPOSED DRIVEWAY

5' Wide Utility Easement

N 85°59'33" W 218.53'

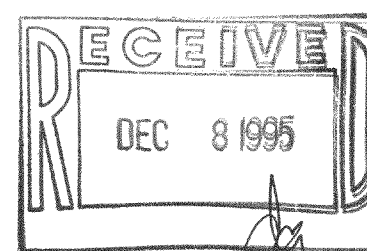

Legend

- FOUND IRON PIPE
- FOUND IRON ROD
- FOUND BRASS CAPPED MONUMENT
- FOUND CONCRETE MONUMENT
- CHISEL CUT IN CONCRETE
- SET IRON ROD, 34" LONG, WEIGHING 1.5 LBS./LINEAL FT., 3/4" DIA.
- SET IRON ROD, 30" LONG, WEIGHING 4.5 LBS./LINEAL FT., 1-11/16" DIA.
- RECORDED AS DIMENSION
- EXISTING FENCE
- UTILITY JUNCTION BOX
- SOILS TEST BORING
- UNDERGROUND UTILITY BOX

SCALE: 1"= 10 FEET



REVISED 10/11/95 (proposed residence added)
REVISED 11/15/95 (AS BUILT LOCATION)

"I hereby certify that the above described property has been surveyed by me or under my direction and that the above map is a true representation thereof and shows the size and location of the property, its exterior boundaries, the location of all visible structures and dimensions of all principal buildings thereon, boundary fences, apparent easements, roadways and visible encroachments, if any.
This survey is made for the use of the present owners of the property and also those who purchase, mortgage, or guarantee the title thereof within one year from date hereof."

Kenneth B. Abernathy, Jr.

KENNETH B. ABERNATHY, JR.
WISCONSIN REGISTERED LAND SURVEYOR
S-1594

Date: May 27, 1994 Job No. 1994.513

ABERNATHY and ASSOCIATES

Kenneth B. Abernathy Jr.

Wisconsin Registered Land Surveyor S-1594

W4056 Bray Road
Elkhorn, Wisconsin 53121
Phone: (414) 723-4260 (office)
(414) 723-4813 (residence)

PLAT OF SURVEY

Lot 18 of Evergreen Estates Subdivision, located in the Southwest 1/4 of the Northwest 1/4 and the Southwest 1/4 of the Southwest 1/4 and the Northwest 1/4 of the Southwest 1/4 and the Northeast 1/4 of the Southwest 1/4 and the Southeast 1/4 of the Southwest 1/4 of Section 18, and the Southwest 1/4 of the Northwest 1/4 and the Northwest 1/4 of the Northwest 1/4 and the Northeast 1/4 of the Northwest 1/4 and the Southeast 1/4 of the Northwest 1/4 and the Northwest 1/4 of the Northeast 1/4 of Section 19, Town 3 North, Range 17 East, Town of La Fayette, County of Walworth, State of Wisconsin.

Owners: Preferred Homes, Inc.
2903 Long Rd.
Delavan, Wisconsin 53115

Overlook Court
66' Wide

Edge of Blacktop Roadway Pavement

S 83°04'58.5" E 228.08'

Radius = 800.02'
Arc = 228.86'

NOTE:
WOOD STAKES HAVE BEEN PLACED AT BUILDING CORNERS. BUILDER IS TO VERIFY DIMENSIONS WHICH HAVE BEEN ROUNDED TO THE NEAREST TENTH OF A FOOT TO INSURE PROPER PLAN INTERPRETATION AND CONTACT THIS OFFICE IMMEDIATELY IF ANY DISCREPANCY EXISTS.

SOILS TEST AREA

Lot 18
0.51 Acres +

PROPOSED RESIDENCE

PROPOSED DRIVEWAY

SOUTH 100.00'

66' Wide

Edge of Blacktop Roadway Pavement

6' Wide Utility Easement

N 85°59'33" W 218.53'

REVISED 10/11/95 (proposed residence added)

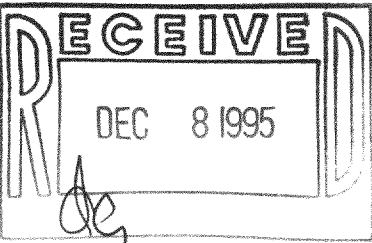

Legend

- FOUND IRON PIPE
- FOUND IRON ROD
- FOUND BRASS CAPPED MONUMENT
- FOUND CONCRETE MONUMENT
- CHISEL CUT IN CONCRETE
- SET IRON ROD, 24" LONG, WEIGHING 1.5 LBS./LINEAL FT., 1/4" DIA.
- SET IRON ROD, 30" LONG, WEIGHING 4.5 LBS./LINEAL FT., 1-11/16" DIA.
- RECORDED AS DIMENSION
- EXISTING FENCE
- UTILITY JUNCTION BOX
- SOILS TEST BORING
- UNDERGROUND UTILITY BOX

SCALE: 1"= 10 FEET

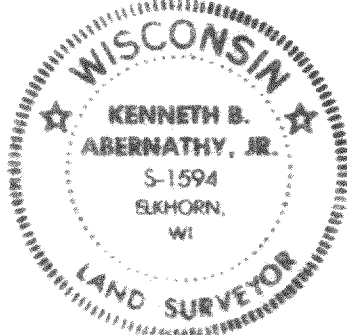

"I hereby certify that the above described property has been surveyed by me or under my direction and that the above map is a true representation thereof and shows the size and location of the property, its exterior boundaries, the location of all visible structures and dimensions of all principal buildings thereon, boundary fences, apparent easements, roadways and visible encroachments, if any."
"This survey is made for the use of the present owners of the property and also those who purchase, mortgage, or guarantee the title thereof within one year from date hereof."

Kenneth B. Abernathy, Jr.
KENNETH B. ABERNATHY, JR.
WISCONSIN REGISTERED LAND SURVEYOR
S-1594

Date: May 27, 1994 Job No. 1994.513

ABERNATHY and ASSOCIATES

Kenneth B. Abernathy Jr.

Wisconsin Registered Land Surveyor S-1594

W4056 Bray Road
Elkhorn, Wisconsin 53121
Phone: (414) 723-4260 (office)
(414) 723-4813 (residence)

PLAT OF SURVEY

Lot 18 of Evergreen Estates Subdivision, located in the Southwest 1/4 of the Northwest 1/4 and the Southwest 1/4 of the Southwest 1/4 and the Northwest 1/4 of the Southwest 1/4 and the Northeast 1/4 of the Southwest 1/4 and the Southeast 1/4 of the Southwest 1/4 of Section 18, and the Southwest 1/4 of the Northwest 1/4 and the Northwest 1/4 of the Northwest 1/4 and the Northeast 1/4 of the Northwest 1/4 and the Southeast 1/4 of the Northwest 1/4 and the Northwest 1/4 of the Northeast 1/4 of Section 19, Town 3 North, Range 17 East, Town of La Fayette, County of Walworth, State of Wisconsin.

Owners: Preferred Homes, Inc.
2903 borg Rd.
Delavan, Wisconsin 53115

Overlook Court
66' Wide

Edge of Blacktop Roadway Pavement

S 83°04'58.5" E 228.08'

Radius = 800.02'
Arc = 228.86'

NOTE:

WOOD STAKES HAVE BEEN PLACED AT BUILDING CORNERS. BUILDER IS TO VERIFY DIMENSIONS WHICH HAVE BEEN ROUNDED TO THE NEAREST TENTH OF A FOOT TO INSURE PROPER PLAN INTERPRETATION AND CONTACT THIS OFFICE IMMEDIATELY IF ANY DISCREPANCY EXISTS.

SOILS TEST AREA

Lot 18
0.51 Acres +

PROPOSED RESIDENCE

PROPOSED DRIVEWAY

SOUTH 100.00'

66' Wide

Edge of Blacktop Roadway Pavement

6' Wide Utility Easement

N 85°59'33" W 218.53'

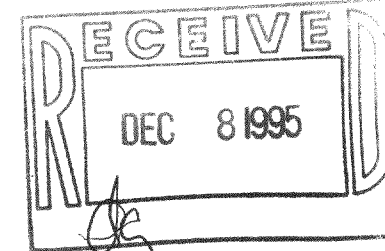

Legend

- FOUND IRON PIPE
- FOUND IRON ROD
- FOUND BRASS CAPPED MONUMENT
- FOUND CONCRETE MONUMENT
- CHISEL CUT IN CONCRETE
- SET IRON ROD, 24" LONG, WEIGHING 1.5 LBS., LINEAL FT., 3/4" DIA.
- SET IRON ROD, 30" LONG, WEIGHING 4.5 LBS., LINEAL FT., 1 1/16" DIA.
- RECORDED AS DIMENSION
- EXISTING FENCE
- UTILITY JUNCTION BOX
- SOILS TEST BORING
- UNDERGROUND UTILITY BOX

SCALE: 1"= 10 FEET

I hereby certify that the above described property has been surveyed by me or under my direction and that the above map is a true representation thereof and shows the size and location of the property, its exterior boundaries, the location of all visible structures and dimensions of all principal buildings thereon, boundary fences, apparent easements, roadways and visible encroachments, if any. This survey is made for the use of the present owners of the property and also those who purchase, mortgage or guarantee the use thereof within one year from date hereof.

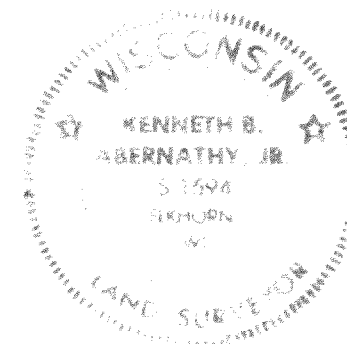

REVISED 10/11/95 (proposed residence added)

KENNETH B. ABERNATHY, JR.
WISCONSIN REGISTERED LAND SURVEYOR
S-1594

Date: May 27, 1994 Job No. 1994.513

KE-18
317-316p